

ANEL LIVRE

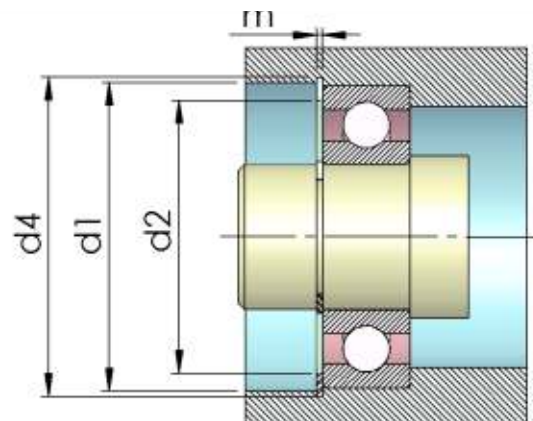

MEDIDAS		ANEL									CANAL			
Ø NOMINAL	s	tol.	b	Tol.	d3	Tol.	e	r min.	Material utilizado (kg x mm)	Peso p/ kg/1000	d ₂	Tol.	m	Tol.
30	1.12	-0.1	3.25	-0.15	27.4	+0.4	3	0.4	3200	2.78	28.17	-0.25	1.35	+0.3
32	1.12	-0.1	3.25	-0.15	29.4	+0.4	3	0.4	3000	2.98	30.15	-0.25	1.35	+0.3
35	1.12	-0.1	3.25	-0.15	32.4	+0.4	3	0.4	2800	3.22	33.17	-0.25	1.35	+0.3
37	1.12	-0.1	3.25	-0.15	34.0	+0.4	3	0.4	2660	3.36	34.77	-0.25	1.35	+0.3
40	1.12	-0.1	3.25	-0.15	37.3	+0.4	3	0.4	2420	3.60	38.10	-0.25	1.35	+0.3
42	1.12	-0.1	3.25	-0.15	38.9	+0.5	3	0.4	2340	3.75	39.75	-0.25	1.35	+0.3
44	1.12	-0.1	3.25	-0.15	40.9	+0.5	3	0.4	2260	4.00	41.75	-0.25	1.35	+0.3
47	1.12	-0.1	4.04	-0.15	43.7	+0.5	4	0.4	2560	5.30	44.60	-0.25	1.35	+0.3
50	1.12	-0.1	4.04	-0.15	46.7	+0.5	4	0.4	2430	5.78	47.60	-0.25	1.35	+0.3
52	1.12	-0.1	4.04	-0.15	48.8	+0.5	4	0.4	2340	5.92	49.73	-0.25	1.35	+0.3
55	1.12	-0.1	4.04	-0.15	51.7	+0.5	4	0.4	2200	6.17	52.60	-0.25	1.35	+0.3
56	1.12	-0.1	4.04	-0.15	52.4	+0.8	4	0.4	2280	6.50	53.60	-0.25	1.35	+0.3
58	1.12	-0.1	4.04	-0.15	54.4	+0.8	4	0.4	2180	6.54	55.60	-0.25	1.35	+0.3
62	1.70	-0.1	4.04	-0.15	58.2	+0.8	4	0.6	6900	10.50	59.61	-0.25	1.90	+0.3
65	1.70	-0.1	4.04	-0.15	61.2	+0.8	4	0.6	7000	11.00	62.60	-0.25	1.90	+0.3
68	1.70	-0.1	4.85	-0.15	63.4	+0.8	5	0.6	7500	12.60	64.82	-0.50	1.90	+0.3
72	1.70	-0.1	4.85	-0.15	67.4	+0.8	5	0.6	7100	14.70	68.81	-0.50	1.90	+0.3
75	1.70	-0.1	4.85	-0.15	70.4	+0.8	5	0.6	6700	15.30	71.83	-0.50	1.90	+0.3
80	1.70	-0.1	4.85	-0.15	75.4	+0.8	5	0.6	6400	16.30	76.81	-0.50	1.90	+0.3
85	1.70	-0.1	4.85	-0.15	80.4	+0.8	5	0.6	6100	17.50	81.81	-0.50	1.90	+0.3
90	2.46	-0.1	4.85	-0.15	85.4	+0.8	5	0.7	17400	26.60	86.79	-0.50	2.70	+0.3
95	2.46	-0.1	4.85	-0.15	90.4	+0.8	5	0.7	16400	28.20	91.82	-0.50	2.70	+0.3
100	2.46	-0.1	4.85	-0.15	95.2	+1.0	5	0.7	15500	29.20	96.80	-0.50	2.70	+0.3
110	2.46	-0.1	4.85	-0.15	105.2	+1.0	5	0.7	14300	32.80	106.81	-0.50	2.70	+0.3
115	2.46	-0.1	4.85	-0.15	110.2	+1.0	5	0.7	13600	33.40	111.81	-0.50	2.70	+0.3
120	2.82	-0.1	7.21	-0.15	113.6	+1.0	7	0.7	29000	60.60	115.21	-0.50	3.10	+0.3
125	2.82	-0.1	7.21	-0.15	118.6	+1.0	7	0.7	28000	63.00	120.22	-0.50	3.10	+0.3
130	2.82	-0.1	7.21	-0.15	123.6	+1.0	7	0.7	27000	65.60	125.22	-0.50	3.10	+0.3
140	2.82	-0.1	7.21	-0.15	133.0	+1.6	7	0.7	25000	70.60	135.23	-0.50	3.10	+0.3
145	2.82	-0.1	7.21	-0.15	138.0	+1.6	7	0.7	24000	73.00	140.23	-0.50	3.10	+0.3
150	2.82	-0.1	7.21	-0.15	142.9	+1.6	7	0.7	23500	77.20	145.24	-0.50	3.10	+0.3
160	2.82	-0.1	7.21	-0.15	152.9	+1.6	7	0.7	22000	81.00	155.22	-0.50	3.10	+0.3
170	3.10	-0.1	9.60	-0.15	161.3	+1.6	10	0.7	36000	122.00	163.65	-0.50	3.50	+0.3
180	3.10	-0.1	9.60	-0.15	171.2	+1.6	10	0.7	34500	128.00	173.66	-0.50	3.50	+0.3
190	3.10	-0.1	9.60	-0.15	181.0	+1.8	10	0.7	32800	139.00	183.64	-0.50	3.50	+0.3

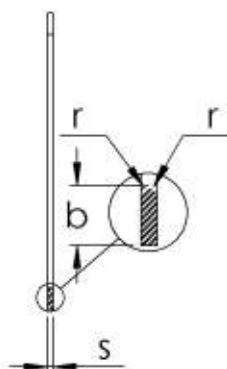
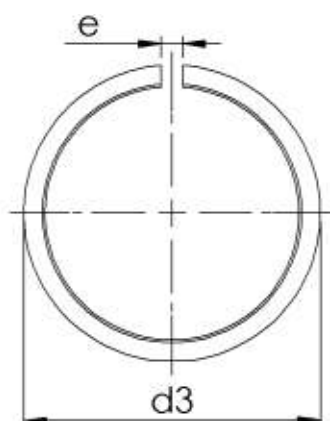

ANEL LIVRE

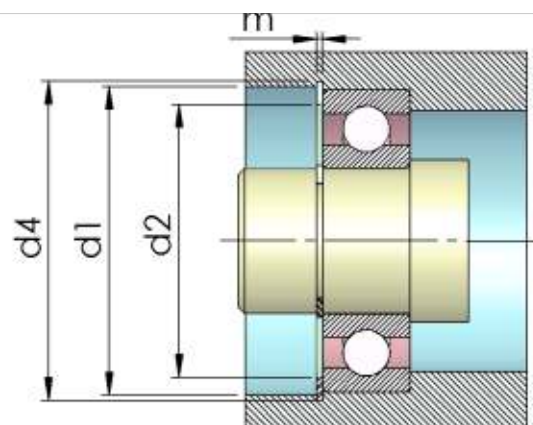
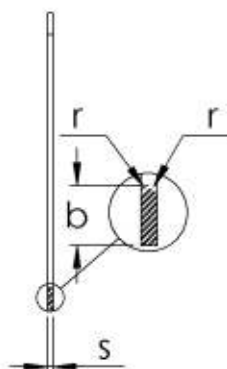

MEDIDAS		ANEL									CANAL			
Ø NOMINAL	s	tol.	b	Tol.	d3	Tol.	e	r min.	Material utilizado (kg x mm)	Peso p/ kg/1000	d ₂	Tol.	m	Tol.
200	3.10	-0.1	9.60	-0.15	191.0	+1.8	10	0.7	31200	148.00	193.65	-0.5	3.50	+0.3
210	3.10	-0.1	9.60	-0.15	200.9	+1.8	10	1.2	29800	156.00	203.60	-0.5	3.50	+0.3
215	3.10	-0.1	9.60	-0.15	205.9	+1.8	10	1.2	28800	165.00	208.60	-0.5	3.50	+0.3
225	3.50	-0.1	10.00	-0.15	214.3	+1.8	10	1.2	47400	195.00	217.00	-0.5	4.50	+0.4
230	3.50	-0.1	10.00	-0.15	219.2	+1.8	10	1.2	40600	200.00	222.00	-0.5	4.50	+0.4
240	3.50	-0.1	10.00	-0.15	229.2	+1.8	10	1.2	39200	208.00	232.00	-0.5	4.50	+0.4
250	3.50	-0.1	10.00	-0.15	239.2	+1.8	10	1.2	37300	217.00	242.00	-0.5	4.50	+0.4
260	3.50	-0.1	10.00	-0.15	249.0	+1.8	10	1.2	36200	226.00	252.00	-0.5	4.50	+0.4
270	3.50	-0.1	10.00	-0.15	259.0	+2.0	10	1.2	34800	234.00	262.00	-0.5	4.50	+0.4
280	3.50	-0.1	10.00	-0.15	269.0	+2.0	10	1.2	33500	243.00	272.00	-0.5	4.50	+0.4
290	3.50	-0.1	10.00	-0.15	279.0	+2.0	10	1.2	32300	252.00	282.00	-0.5	4.50	+0.4
300	4.50	-0.2	12.00	-0.30	286.0	+2.0	10	1.5	79500	394.00	290.00	-0.5	5.50	+0.5
310	4.50	-0.2	12.00	-0.30	296.0	+2.0	10	1.5	77000	407.00	300.00	-0.5	5.50	+0.5
320	4.50	-0.2	12.00	-0.30	306.0	+2.0	10	1.5	74700	420.00	310.00	-0.5	5.50	+0.5
340	4.50	-0.2	12.00	-0.30	326.0	+2.0	10	1.5	70200	446.00	330.00	-0.5	5.50	+0.5
350	4.50	-0.2	12.00	-0.30	345.0	+2.0	10	1.5	66000	473.00	350.00	-0.5	5.50	+0.5
370	4.50	-0.2	12.00	-0.30	355.0	+2.0	10	1.5	64000	486.00	360.00	-0.5	5.50	+0.5
380	4.50	-0.2	12.00	-0.30	365.0	+2.0	10	1.5	63000	498.00	370.00	-0.5	5.50	+0.5
400	4.50	-0.2	12.00	-0.30	385.0	+2.0	10	1.5	60100	525.00	390.00	-0.5	5.50	+0.5

Material: Aço Mola

Dureza: HRC-45-50

Tratamento de Superfície: Oleado

Outros materiais e acabamentos sob encomenda.